

Kołnierze zaślepiające wg EN1092-1 typ 05 PN25

DOSTĘPNE GATUNKI

| Szeroki wybór | | Ograniczony wybór | |
|---------------|--------|-------------------|--------|
| 1.4301/1.4307 | 1.4541 | 1.4306 | 1.4462 |
| 1.4404 | 1.4571 | 1.4435 | 1.4539 |

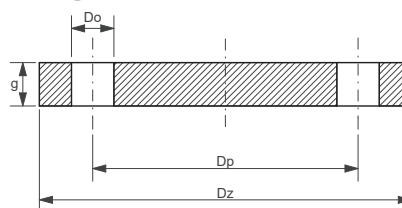

| DN | KOŁNIERZ | | | ŚRUBY | | | WAGA [KG] |
|------|----------|--------|---------|--------|-------|---------|-----------|
| | Dz [MM] | g [MM] | Dp [MM] | liczba | gwint | Do [MM] | |
| 10 | 90 | 16 | 60 | 4 | M12 | 14 | 0,72 |
| 15 | 95 | 16 | 65 | 4 | M12 | 14 | 0,81 |
| 20 | 105 | 18 | 75 | 4 | M12 | 14 | 1,14 |
| 25 | 115 | 18 | 85 | 4 | M12 | 14 | 1,38 |
| 32 | 140 | 18 | 100 | 4 | M16 | 18 | 2,03 |
| 40 | 150 | 18 | 110 | 4 | M16 | 18 | 2,35 |
| 50 | 165 | 20 | 125 | 4 | M16 | 18 | 3,20 |
| 65 | 185 | 22 | 145 | 8 | M16 | 18 | 4,29 |
| 80 | 200 | 24 | 160 | 8 | M16 | 18 | 5,54 |
| 100 | 235 | 24 | 190 | 8 | M20 | 22 | 7,6 |
| 125 | 270 | 26 | 220 | 8 | M24 | 26 | 10,8 |
| 150 | 300 | 28 | 250 | 8 | M24 | 26 | 14,6 |
| 200 | 360 | 30 | 310 | 12 | M24 | 26 | 22,5 |
| 250 | 425 | 32 | 370 | 12 | M27 | 30 | 33,5 |
| 300 | 485 | 34 | 430 | 16 | M27 | 30 | 46,3 |
| 350 | 555 | 38 | 490 | 16 | M30 | 33 | 68,1 |
| 400 | 620 | 40 | 550 | 16 | M33 | 36 | 89,7 |
| 450 | 670 | 50 | 600 | 20 | M33 | 36 | 130 |
| 500 | 730 | 51 | 660 | 20 | M33 | 36 | 159 |
| 600 | 845 | 66 | 770 | 20 | M36 | 39 | 278 |
| 700 | 960 | - | 875 | 24 | M39 | 42 | - |
| 800 | 1085 | - | 990 | 24 | M45 | 48 | - |
| 900 | 1185 | - | 1090 | 28 | M45 | 48 | - |
| 1000 | 1320 | - | 1210 | 28 | M52 | 56 | - |
| 1200 | 1530 | - | 1420 | 32 | M52 | 56 | - |
| 1400 | 1755 | - | 1640 | 36 | M56 | 62 | - |
| 1600 | 1975 | - | 1860 | 40 | M56 | 62 | - |
| 1800 | 2195 | - | 2070 | 44 | M64 | 70 | - |
| 2000 | 2425 | - | 2300 | 48 | M64 | 70 | - |



ASKO - TECH

STAL NIERDZEWNA I KWASOODPORNA

ul. Szczawiowa 57 A, 70-010 Szczecin, tel. 91 485 10 50, fax: 91 482 32 82
www.askotech.com.pl, e-mail: szczecin@askotech.com.pl